











CROWNE PLAZA LEEDS

Meetings & Events Fact Sheet

Close to the city centre and motorway links. Crowne Plaza Leeds has seven impressive meeting rooms and can cater for everything from an intimate business gathering to a conference for 200. With climate control and free WiFi throughout, guests can also enjoy fresh coffee in the large breakout area, or on the terrace outside.



 No. of bedrooms 135	 54 twin rooms available	 Gym	 Pool
 102 parking spaces on-site £17.50 24 hrs Mon-Sun	 4 electric charging points	 Leeds Station (0.4 miles)	 Leeds Bradford (8.1 miles)
 7 meeting rooms	 Air conditioning in all M&E rooms	 Outdoor dining capacity of 20	

GROUND

	Dimensions (sq ft)	Classroom	Theatre	Boardroom	Cabaret	Banqueting
Executive Boardroom	238.4	N/A	N/A	12	N/A	12
Gledhow Room	240.4	12	20	15	N/A	15
Headingley Suite	1,064	36	70	30	42	60
Kirkstall Room	236	12	20	15	N/A	15
Roundhay Suite	2,216.1	90	200	60	105	150
Roundhay Suite 1	1,078.5	48	70	40	56	60
Roundhay Suite 2	584.6	24	40	26	24	30
Roundhay Suite 3	586.8	24	40	26	24	30
Roundhay 1&2	1,645	66	150	50	72	80
Roundhay 2&3	1,161.6	48	70	40	48	60

FLOOR PLAN

Executive Boardroom

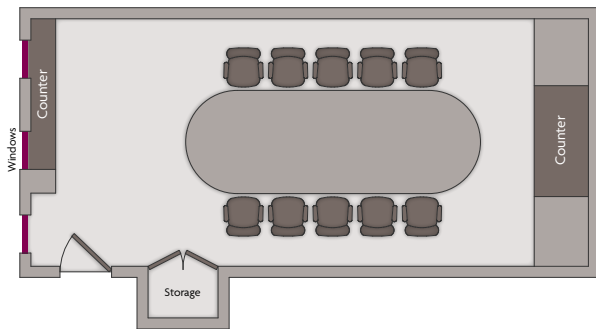

Gledhow

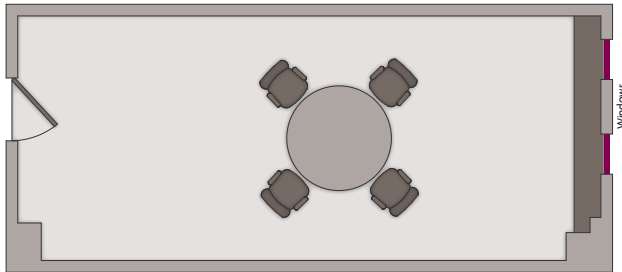

Headingley Suite

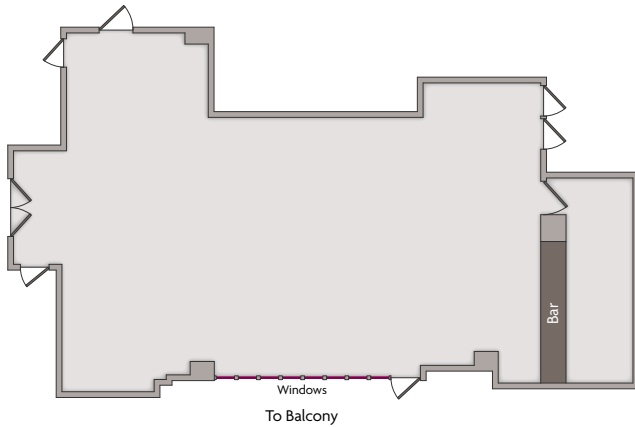

Kirkstall

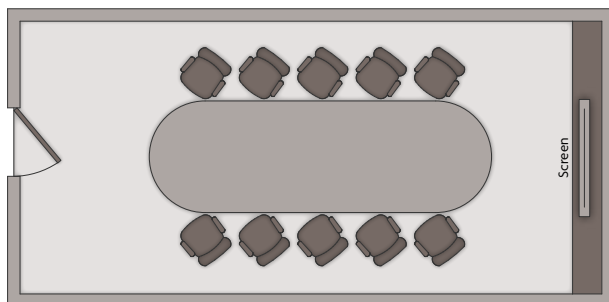

Roundhay Suite 1

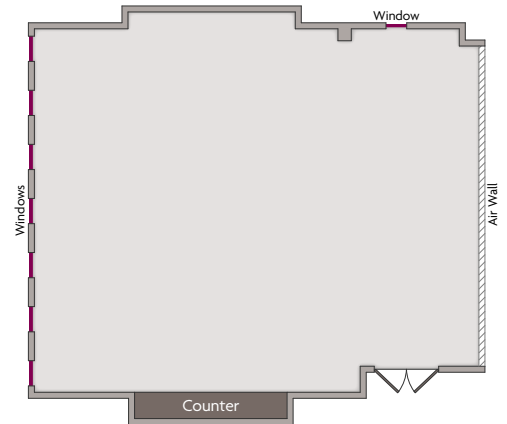

Roundhay Suite 2

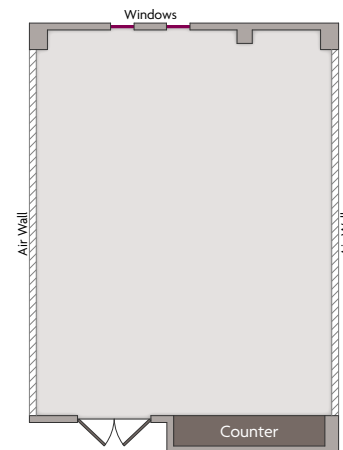

Roundhay Suite 3

